

BT7852

SYSTEM 2™ SWIVEL ADAPTER FOR Ø2" POLES

The BT7852 allows a screen or AV equipment mounted at the bottom of a Ø2" pole to be swivelled 360°. Used in conjunction with the System 2 range of ceiling mounts, the swivel adapter connects two BT7850 poles together and is an ideal component for a flat screen ceiling mount where the display needs to be repositioned in various directions once mounted. The swivel action features a moderate resistance to prevent any unwanted movement and has cable management holes for a tidy install.

SPECIFICATIONS



Max load (Single Sided Screen)	154lbs
Max load (Back-to-back)	77lbs per screen
Swivel	360°
Steel thickness	0.15"
Color	Black



FEATURES

- 1 Designed for use with System 2 components such as BT7850 Ø2" poles
 - 2 Ideal for mounting screens to the ceiling with the ability to swivel 360°
 - 3 Also suitable for back-to-back and floor-to-ceiling installations
 - 4 Integrated cable management
- Includes cover plate for a tidy installation
 - Heavy-duty steel capable of supporting substantial loads
 - Multiple grub screws allow micro-adjustment of the pole



<p>MAX LOAD</p>  <p>154lbs</p>	<p>SWIVEL</p>  <p>360°</p>	
---	---	---

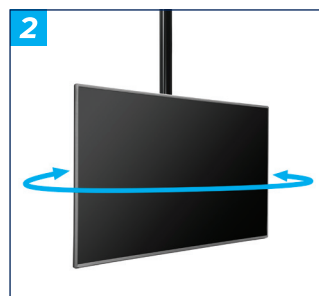

BT7852

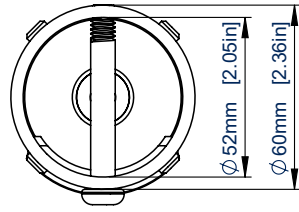

TOP VIEW

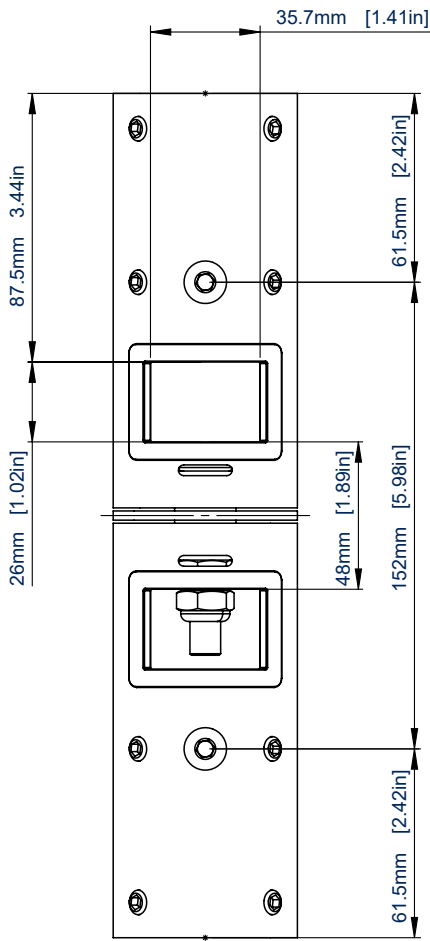

FRONT VIEW

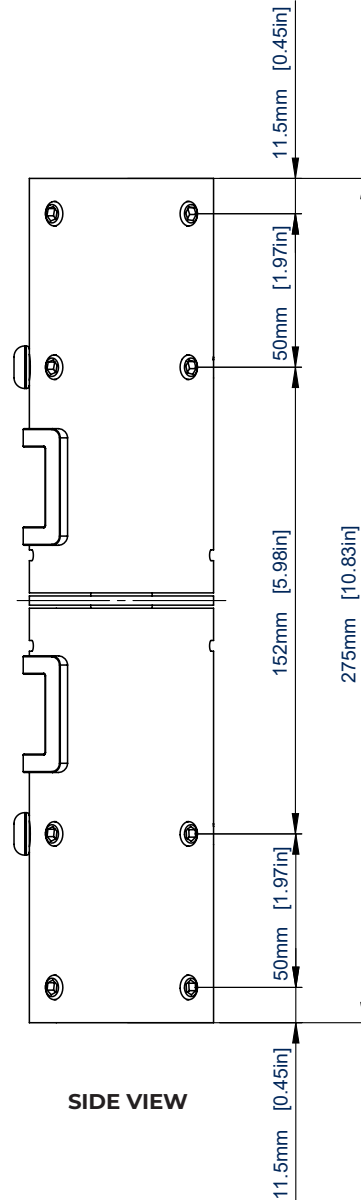

SIDE VIEW

ORDERING INFORMATION

COLOR	ORDER REF	UPC
Black	BT7852/B	811867030075

RELATED PRODUCTS

PRODUCT CODE	NAME	DESCRIPTION
BT7850	System 2 Ø2" Poles	Available in a variety of lengths to create multiple pole-mounted solutions
BT7807	System 2 Floor / Ceiling Mount	Mount twin poles from the floor or ceiling using Ø2" poles
BT7851	System 2 Adjustable Drop Ceiling Mount	Adjustable drop in 0.98" increments for easy positioning the screens
BT7056	System 2 Floor Fixing Kit	Allows Ø2" poles to be fixed to the floor without requiring bolting

© 2018 B-Tech AV Mounts Corporation Ltd. All rights reserved.
 The information in this specification sheet reflects the current technical specifications at the time of printing.
 We reserve the right to change the technical or physical specifications without prior notice. The B-Tech name and the B-Tech logo are registered trademarks of B-Tech AV Mounts Co. Ltd.
 B-Tech is not responsible for loss or damage caused by improper installation or mounting on unstable structures. Any reproduction or reuse of information or specification of any part of this
 specification sheet is strictly prohibited unless prior written permission is granted by B-Tech AV Mounts Corporation Ltd. (BTL).

SS-BT7852-170424-NA