

BT8390-VESA400MAF

SYSTEM X™ INTERFACE ARMS WITH MICRO-ADJUSTMENT

BT8390-VESA400MAF interface arms have been designed to securely mount medium to large screens onto System X horizontal mounting rails, ideal for creating videowalls and other multi-screen setups. The universal design ensures compatibility with all videowall screens and enables a wide array of configurations in landscape and portrait orientations. Effortless toolless micro-adjustment guarantees precise display alignment, all within an impressively slim 3.38" mounted depth, providing a sleek, close-to-the-wall installation.



SPECIFICATIONS

Recommended screen size	39" - 75"
Max load	110lbs
VESA® & non-VESA fixing	up to 15.74" * (vertical dimension)
Depth (using BT8390-WFK1)	0.33" (+/-0.39" depth adjustment)
Depth (using BT8390-WFK2)	3.39" (+/-0.39" depth adjustment)
Height adjustment	+/-0.98"

FEATURES

- Ideal for videowalls and other multi-screen installations
- Universal design compatible with most screens
- 1 Designed for use with BT8390 System X Rails
- 2 Safety screws help prevent unauthorized removal of screens
- 3 Suitable for landscape or portrait mounting
- Tool-less micro-adjustment for seamless display alignment
- 4 Simple 'hook-on' installation



RECOMMENDED MAX SCREEN 75" 190cm	MAX LOAD 110lbs	MAX VESA 400	MICRO ADJUSTMENT 	POST INSTALL ALIGNMENT 	TÜV CERTIFIED 	
---	---------------------------	------------------------	----------------------	----------------------------	-------------------	--

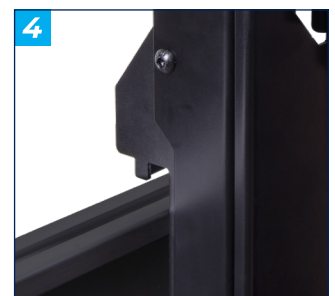

BT8390-VESA400MAF

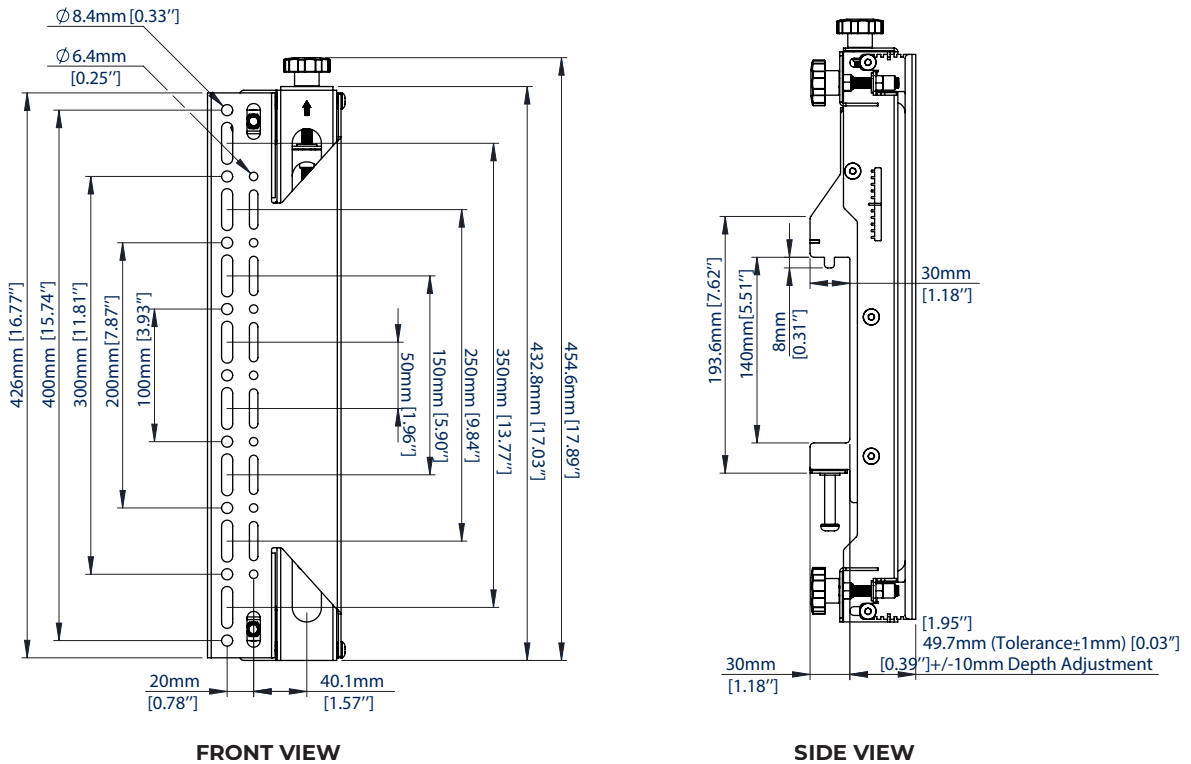

ORDERING INFORMATION

COLOR	ORDER REF	UPC
Black	BT8390-VESA400MAF/B V2	811867039108

RELATED PRODUCTS

PRODUCT CODE	NAME	DESCRIPTION
BT7564	Interface Adapter Arms	Adapter arms for increased VESA fixings up to 600
BT8390	System X Horizontal Rails	Mounting Rails in multiple lengths designed to support a variety of interface arms
BT8390-WFK1	System X Rail Mounting Bracket	Attach BT8390 Mounting Rails to the wall using BT8390-WFK1 Mounting Bracket
BT8390-VESA400MAP	Pop-in, Pop-Out Interface Arms	Alternative Interface Arms with Pop-Out function for easy service access

© 2018 B Tech AV Mounts Co., Ltd. All rights reserved.
 The information in this specification sheet reflects the current technical specifications at the time of printing.
 We reserve the right to change the technical or physical specifications without prior notice. These technical specifications are trademarks of B Tech AV Mounts Co., Ltd.
 B Tech AV Mounts Co., Ltd. is not responsible for any damage caused by improper installation or mounting on unstable structures. Any reproduction or use without permission or registration of any part of this specification sheet is strictly prohibited unless prior written permission is granted by B Tech AV Mounts Co., Ltd.