

MFT6024 Modular Folding Table System

The Modular Folding Table System **MFT6024** is a training and conference room solution for both professional and private bureaus.

AVFI's unique design incorporates hardware with an Intelligent Folding System that allows the tables to be mobile, linked together and easily folded for storage.

Several sizes and shapes are available for modular room layouts and configurations, suitable for conference and training room areas.



MFT6024-2P image shown.



MFT6024-2P connected side by side



MFT6024-2P Folded

Standard Features

- Space-saving table folding system, elegant design, desk frame from grey powder coated steel and locking casters for mobility.
- Highly resistant thermowrap Top surface [surf\(x\)](#) (Check available finishes).
- 2x Power Panels (2x outlet, 2x 2.0A USB) and 2x grommet per table, color: Black (MFT6024-2PSTD does not include power).
- Steel Leveling Desk Top Connectors.
- Ships assembled.

Options

- **CUB22** 3 Module Power panel, Black.
 - 2 Tamper Resistant AC Outlets.
 - Double USB fast charging (3.2A rated).
- **CUBM3** 3 Module Power & Data panel, Black.
 - 2 Tamper Resistant AC Outlets.
 - 1 Cat 6 port (w/pigtail).
- **CUBM4** 4 Module Power & Data panel, Black.
 - 2 Tamper Resistant AC Outlets.
 - 1 Cat 6 port (w/pigtail).
 - 1 HDMI Port.
- **PB** Six outlet power bar with 10ft. cord

TABLE COMPONENTS AVAILABLE

See next page for Typical Configuration and Table dimensions.

- MFT6024-2P 2-Person Folding Table
- MFT6024-2PSTD 2-Person Standard Folding Table (does not include power)
- MFT6024-2PEL 2-Person Folding Table-End Left
- MFT6024-2PER 2-Person Folding Table-End Right
- MFT6024-3PCL 3-Person Folding Table-Corner Left
- MFT6024-3PCR 3-Person Folding Table-Corner Right
- MFT6024-3PL 3-Person Folding Table-Left
- MFT6024-3PR 3-Person Folding Table-Right
- MFT6024-2PW20 2-Person Wedge Folding Table, 20° angle.
- MFT6024-2PWRD 2-Person Wedge Round Folding Table, 45° angle.
- MFT6024-TT60 Triangle Folding Table Extension, 60° angle.
- MFT6024-TTISL Triangle Table Center Island (Option only when 3x MFT6024-TT60 are connected).

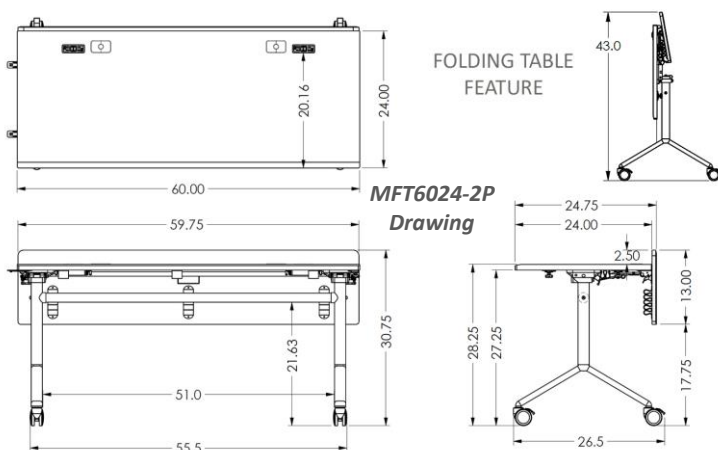

Specifications

Model: MFT6024
Width: 60" - 84.75"
Depth: 24.75"
Height: 30.75"

Finishes:



Other finishes are available. Check website.

The information contained in this drawing is the sole property of Audio Visual Furniture International. Any reproduction in part or as a whole without the written permission of Audio Visual Furniture International is prohibited. We can build or modify stock configurations to suit customer specifications. Please contact us to discuss how this service can help meet your needs. Some quantity restrictions may apply. Specification subject to change without notice. Computers, cameras, monitors, etc. are shown to illustrate product usage and are not included unless otherwise noted.

MFT6024 Modular Folding Table System

**AUDIO VISUAL
FURNITURE
International**

TABLE COMPONENTS

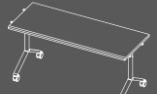

MFT6024-2PSTD
60"W x 24"D x 28.25"H



MFT6024-2P
60"W x 24.75"D x 30.75"H



MFT6024-2PEL
84.75"W x 24.75"D x 30.75"H

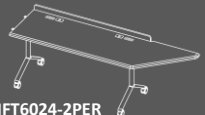

MFT6024-2PER
84.75"W x 24.75"D x 30.75"H



MFT6024-3PCL
84.75"W x 24.75"D x 30.75"H

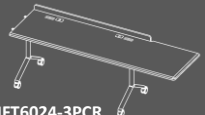

MFT6024-3PCR
84.75"W x 24.75"D x 30.75"H

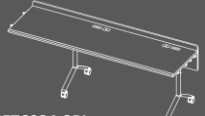

MFT6024-3PL
84.75"W x 24.75"D x 30.75"H



MFT6024-3PR
84.75"W x 24.75"D x 30.75"H



MFT6024-2PW20
63"W x 24"D x 28.25"H



MFT6024-2PWRD
78.75"W x 27"D x 30.75"H



MFT6024-TT60
56"W x 61.6"D x 28.25"H



TYPICAL CONFIGURATIONS

*Chairs are not included

MFT6024 - Boardroom



Table Components Included:
4x MFT6024-2PSTD

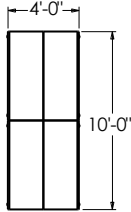

MFT6024 - Learning



Table Components Included:
5x MFT6024-2P

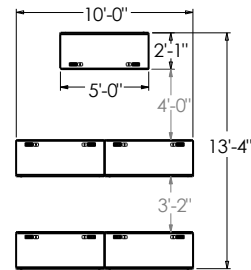

MFT6024 - Back-to-Back



Table Components Included:
8x MFT6024-2P

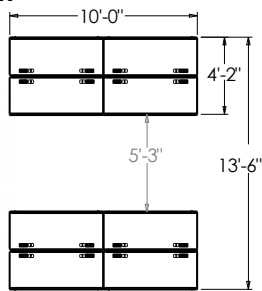

MFT6024 - U-Shape



Table Components Included:
5x MFT6024-2P
1x MFT6024-2PER
1x MFT6024-2PEL

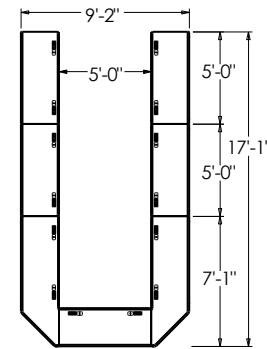

MFT6024 - V-Shape



Table Components Included:
6x MFT6024-2P
1x MFT6024-2PW20

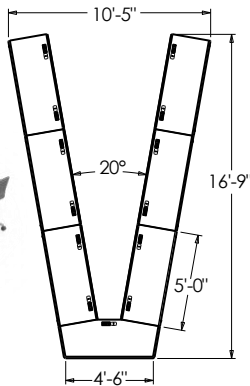

MFT6024 - Square



Table Components Included:
2x MFT6024-2P, 2x MFT6024-3PCL,
2x MFT6024-3PCR

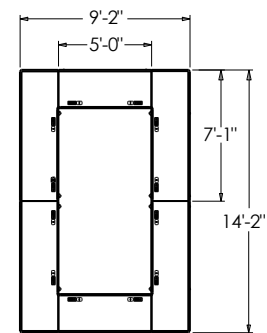

MFT6024 - Triangle

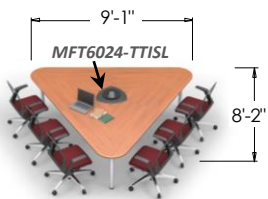

Table Components Included:
3x MFT6024-TT60 connected
1x MFT6024-TTISL Center Island

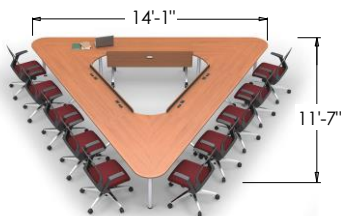

Table Components Included:
3x MFT6024-TT60 connected with
3x MFT6024-2P

MFT6024 - Round

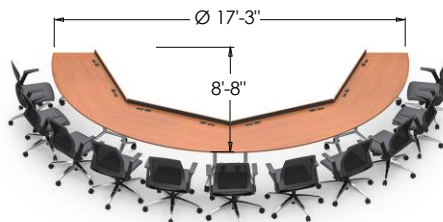

Table Components Included:
4x MFT6024-2PWRD

Note: Allow ± 0.5" on all dimensions

MFT6024 Modular Folding Table System



FEATURES

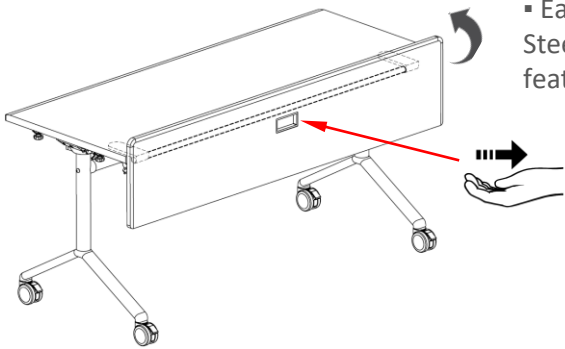

▪ Easy to use, space-saving table folding system. Steel desk frame is powder coated grey and features locking casters for mobility.



- Highly resistant thermowrap Top surface [surf\(x\)](#) (Check available finishes).
- Integrated 2x Power Panels (2x outlet, 2x Fast charging 3.2A USB) and 2x grommet per table, color: Black



OPTIONAL POWER & DATA

- **CUBM3** 3 Module Power & Data panel, Black.
 - 2 Tamper Resistant AC Outlets.
 - 1 Cat 6 port (w/pigtail).



- **CUBM4** 4 Module Power & Data panel, Black.
 - 2 Tamper Resistant AC Outlets.
 - 1 Cat 6 port (w/pigtail).
 - 1 HDMI Port.



▪ Integrated under work surface Cable Clamps with slots for cable management .

▪ Steel Leveling Desk Top Connectors synchronizes firm connections.

